

**KEEP FOR FUTURE REFERENCE**



**P.O. Box 368 – 908 West Main  
Laurel, MT USA 59044  
phone 800-548-7341  
phone 406-628-8231  
fax 406-628-8354**

# INSTRUCTIONS

International Version

STOCK NUMBERS: 59906



**RADIO REMOTE CONTROL OPTION  
RETROFIT KIT INSTALLATION  
FOR INTELLI-GRIP®-ENABLED LIFTERS**



***READ ALL INSTRUCTIONS AND WARNINGS  
BEFORE USING THIS PRODUCT***



**DESIGNED FOR THE MATERIALS HANDLING PROFESSIONAL**



# INSTALLATION

Find your lifter from the sections below and follow the instructions listed there:

## P1-DC3

- 1) Remove the power cable clip (circled).
- 2) Align the two holes on the radio receiver's mounting plate with the holes on the pad frame. Insert screws and tighten securely.
- 3) Route the radio receiver's cable through the lifter to avoid tangling or pinching while in use (see 4 & 7).
- 4) Route the radio receiver cable underneath the lift bar beside vacuum hoses.
- 5) Remove the vacuum pump cover and route the connection cable around edge (see 7).
- 6) Plug the radio receiver's cable into Intelli-Grip® control unit.
- 7) Ensure the cable is routed to avoid tangling or damage during lifter operation. Reinstall the vacuum pump cover (see 5).
- 8) Perform all inspections and tests, as directed in the MAINTENANCE section of the lifter's instructions.  
***Make sure that all components of the Remote Control System are functioning correctly.***

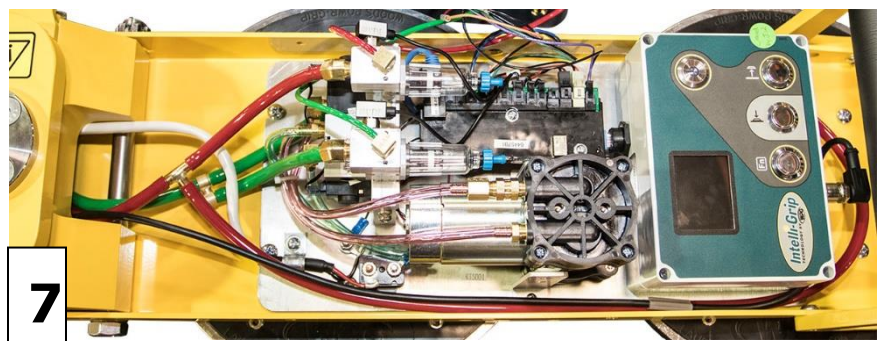
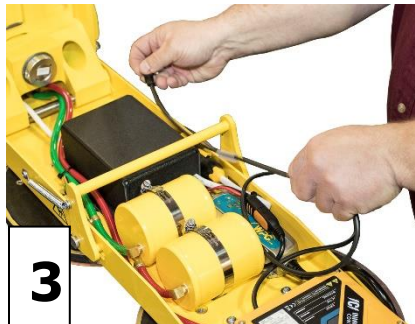

# MRT4-DC3

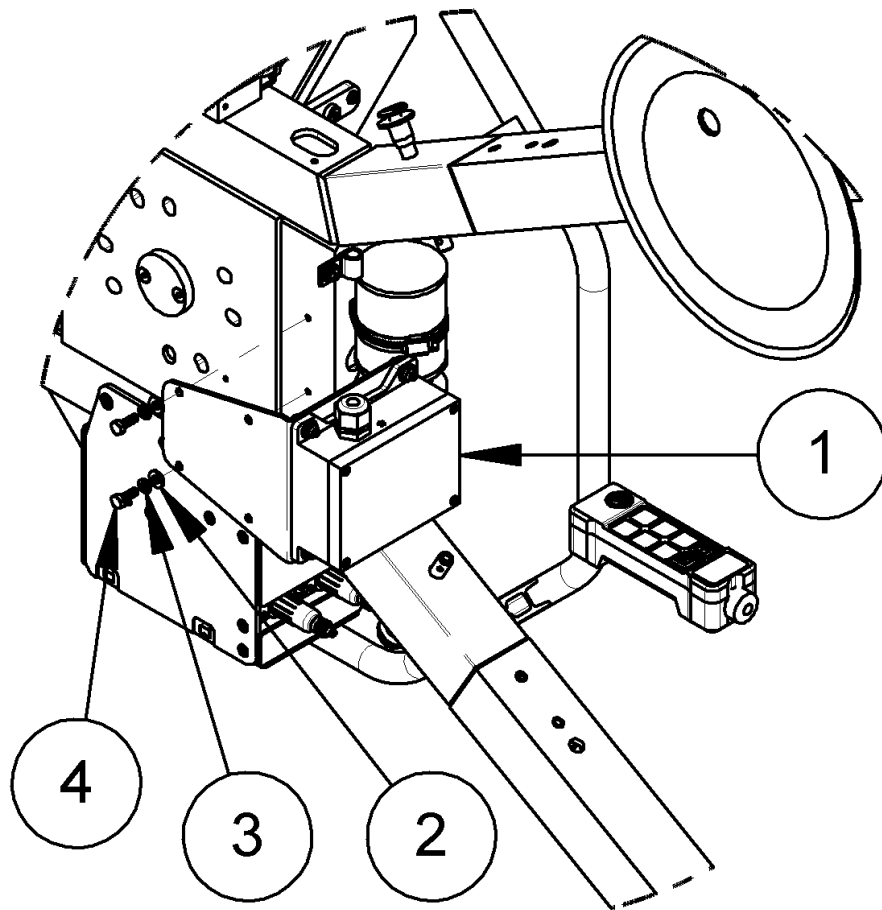

- 1 RADIO RECEIVER
- 2 FLAT WASHER
- 3 LOCK WASHER
- 4 1/4-20 BOLT

- 1) Push each of the bolts through a lock washer and then a flat washer. Align the two holes on the radio receiver's mounting plate with the corresponding holes on the pad frame. Insert the bolts and tighten securely.
- 2) Connect the end of the radio receiver's cable into the Intelli-Grip® control unit.  
**Note:** Route cable to avoid tangling or pinching while the lifter is in use. Use a wire clip to secure the cable, if needed.
- 4) Perform all inspections and tests before using lifter, as directed in the MAINTENANCE section of the lifter's instructions. ***Make sure that all components of the Remote Control System are functioning correctly.***

# MRTA8-DC3

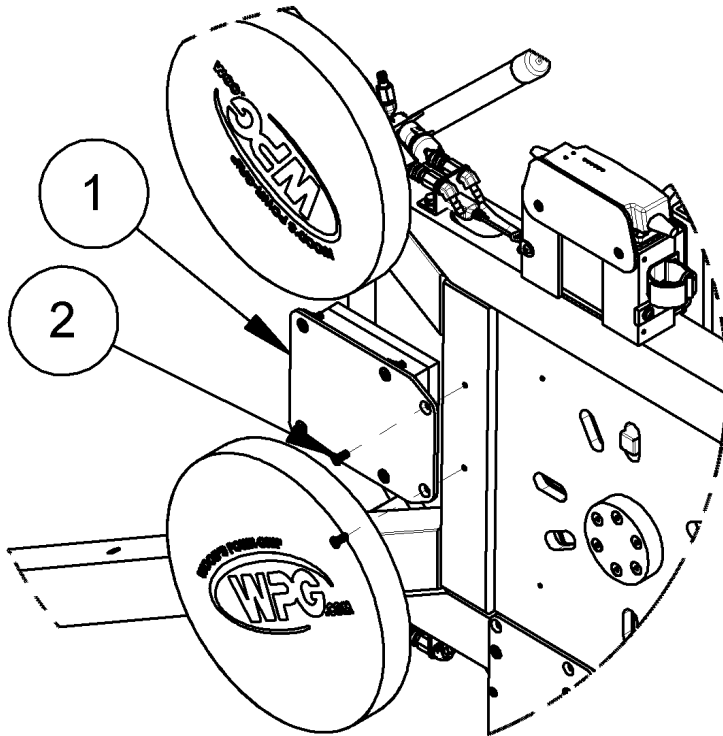

- 1 RADIO RECEIVER
- 2 ¼-20 FLAT-HEAD SCREW

# MRTALP-DC3

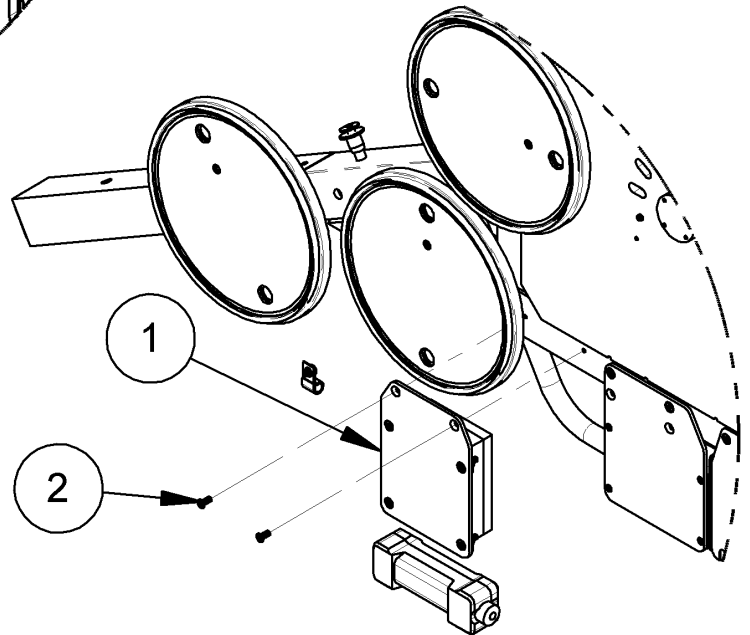

- 1) Align the radio receiver's two holes with the holes on the pad frame. Insert the screws and tighten securely. Use a medium strength thread-locker to secure the screws if needed.
- 2) Connect the end of the radio receiver's cable to the Intelli-Grip control unit.  
**Note:** Route cable to avoid tangling or pinching while the lifter in use. Use a wire clip to secure the cable, if necessary.
- 4) Perform all inspections and tests before using lifter, as directed in the MAINTENANCE section of the lifter's instructions. ***Make sure that all components of the Remote Control System are functioning correctly.***

# LIMITED WARRANTY

---

Powr-Grip products are carefully constructed, thoroughly inspected at various stages of production, and individually tested. They are warranted to be free from defects in workmanship and materials for a period of one year from the date of purchase.

If a problem develops during the warranty period, follow the instructions hereafter to obtain warranty service. If inspection shows that the problem is due to defective workmanship or materials, Powr-Grip will repair the product without charge.

## **WARRANTY DOES NOT APPLY WHEN:**

Modifications have been made to the product after leaving the factory.

Rubber portions have been cut or scratched during use.

Repairs are required due to abnormal wear and tear.

The product has been damaged, misused, or neglected.

If a problem is not covered under warranty, Powr-Grip will notify the customer of costs prior to repair. If the customer agrees to pay all repair costs and to receive the repaired product on a C.O.D. basis, Powr-Grip then will proceed with repairs.

## **TO OBTAIN REPAIRS OR WARRANTY SERVICE**

For purchases in *North America*:

Contact the Technical Service Department at Wood's Powr-Grip Co. When factory service is required, ship the complete product—prepaid—along with your name, address and phone number to the street address hereafter.

For purchases in *all other localities*:

Contact your dealer or the Technical Service Department at Wood's Powr-Grip Co. for assistance.

Wood's Powr-Grip Co., Inc.  
908 West Main St. / P.O. Box 368  
Laurel, MT USA 59044

phone 800-548-7341

phone 406-628-8231

fax 406-628-8354